

## Two-Piece Single-Use Face Shield (Part # DFS-2-US) Assembly Instruction

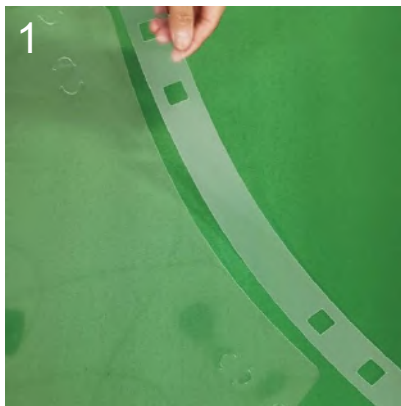

Align Head Strap with Clear Shield.

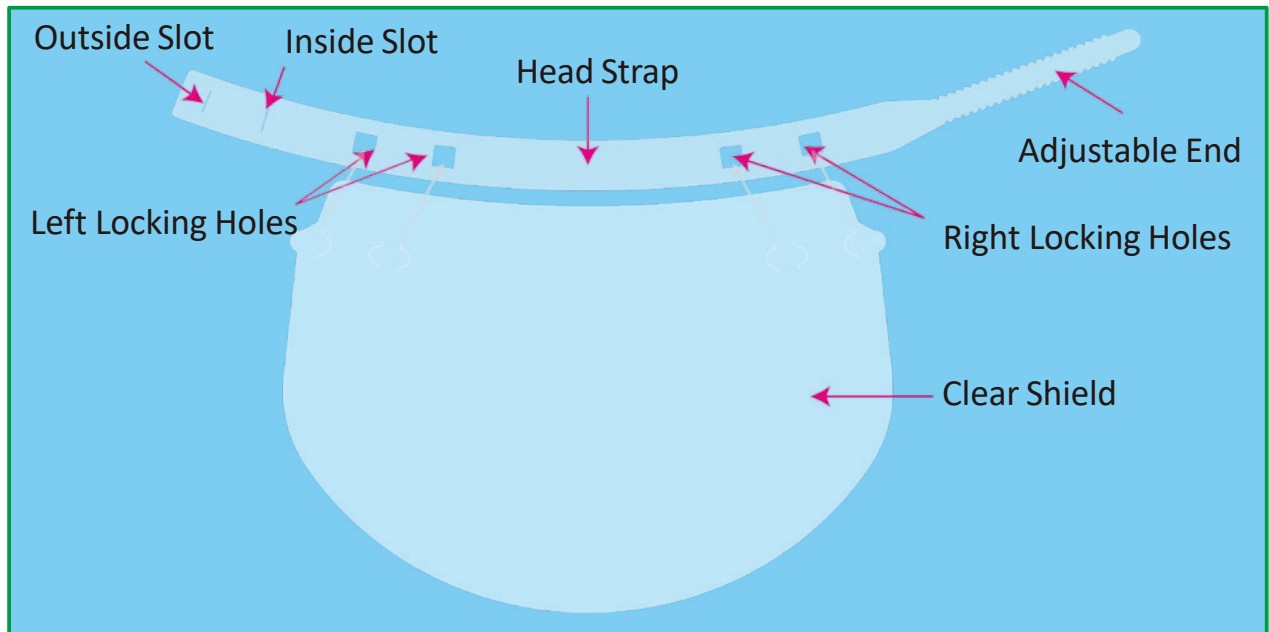
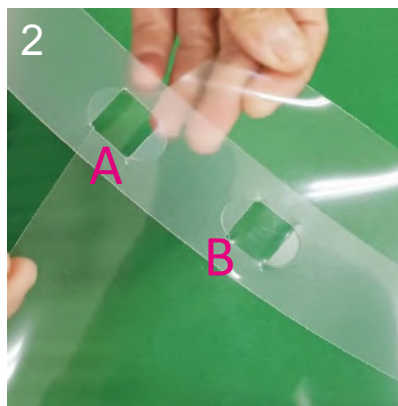

Insert and lock left-side Clear Shield tabs into left-side Locking Holes A and B.

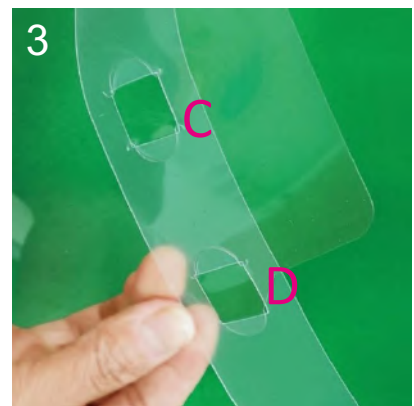

Do the same with right-side Clear Shield tabs and right-side Locking Holes C and D.

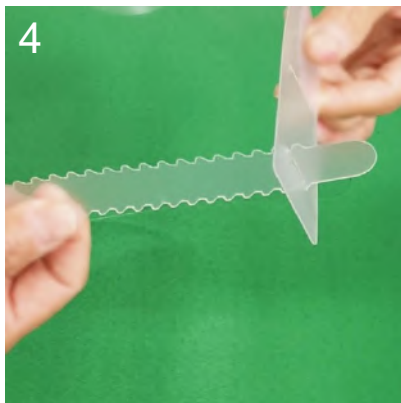

Circle the Head Strap (Clear Shield to outside) and insert Adjustable End into Outside Slot.

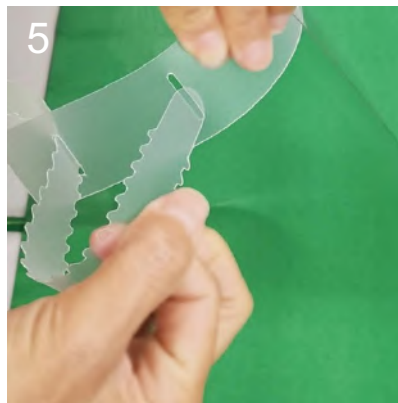

Once approximately sized, insert the Adjustable End into the Inside Slot.

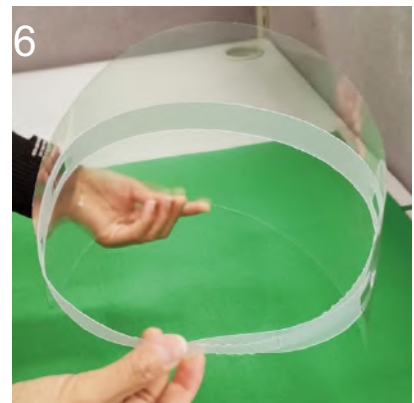

Assembly Complete. Fine-tune Adjustable End if required.